



EICA:RATHO
Edinburgh International
Climbing Arena



CONFERENCE, EVENTS AND TEAM BUILDING





“

THE VENUE WAS SPECTACULAR AND THE EVENT PLANNING FLAWLESS. ALL OUR GUESTS WERE VERY IMPRESSED AND HAD A FANTASTIC DAY.

”

Audi

CONFERENCE, EVENTS AND TEAM BUILDING AT EICA

As a corporate venue EICA:Ratho is contemporary, yet timeless, making it a distinctly different and inspirational destination for business. With the original quarry walls running through many of the conference and events spaces, and with breathtaking views of the surrounding countryside, this is a truly unique and inspirational venue.

So, whether you're holding a small informal meeting, a conference or seminar, team building or incentive day, or perhaps a blend of the above; there is a room in our impressive portfolio to suit.

Our highly experienced and dedicated events team will be delighted to assist in every aspect of your event. From the initial planning stage, this professional team will advise and organise everything you need. Whether it's hospitality, catering or team building we can arrange it all for you.

LEAVE A LASTING IMPRESSION WITH AN EVENT IN A TRULY INSPIRATIONAL SETTING



ARENA

Impress your guests in this truly unique space; the world's largest indoor climbing arena. With 100ft walls and extraordinary backdrops, it is an inspirational location for every type of event.

With the help of your designated events organiser, the space can be dressed and styled to suit your needs.

Ideal for large conferences, presentations, product launches, parties, sporting and music events, or just something different

Enclosed restrooms

Natural light

Breakout space

Exhibitions

CAPACITY:



HEIGHT (M) 30.00

AREA (M²) 2331

DIMENSIONS (M) 58x41

A GREAT BIG SPACE...
THE POSSIBILITIES FOR
USE ARE LIMITED ONLY
BY YOUR IMAGINATION



HASTON SUITE

The Haston Suite is located on the top floor of the building, opening out onto the impressive fifth floor open plan atrium. It offers stunning views of the surrounding countryside to the front and beautiful views of the landscaped quarry and original rockface to the rear. With its traditional yet contemporary design, it is the ideal space for any event.

Ideal for banquets, parties, large conferences and other corporate events

Enclosed restrooms

Blackout blinds for all windows

Breakout space

Natural light

WiFi Internet access

CAPACITY:

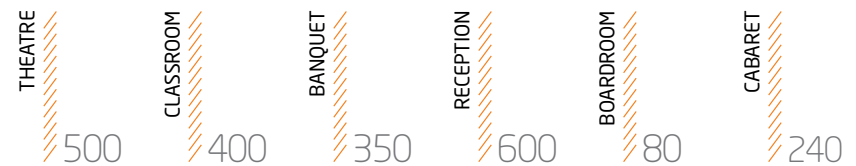

HEIGHT (M) 3.00

AREA (M²) 530.75

DIMENSIONS (M) 24x27



IN A CONTEMPORARY
STYLE IT OFFERS STUNNING
PANORAMIC VIEWS OF THE
SURROUNDING COUNTRYSIDE



RAEBURN SUITE

Located directly opposite the Haston Suite, the Raeburn Suite has a unique yet elegant style. It is perfect for smaller presentations, conferences, formal or informal dining and meetings. It's also an ideal breakout room when used with the Haston Suite. With a decorative open fireplace and floor to ceiling windows looking onto the spectacular climbing arena, it perfectly combines a traditional alpine lodge feel with a modern events space.

Ideal for receptions, formal / informal dining, large / small meetings and conferences

Fully functioning bar area

Raised area suitable as a dance floor

Cloakroom

WiFi Internet access

Breakout space

CAPACITY:



HEIGHT (M) 3.00

AREA (M²) 521+ BAR

DIMENSIONS (M) 32x25



MURRAY LECTURE THEATRE

Located on the fourth floor, the Murray Lecture Theatre is a beautifully designed room with retractable tiered seating and backed by an original rockface wall. It can be used independently or with the Patey Suite next door.

Ideal for presentations, screenings, seminars, boardroom meetings and other corporate events

Featuring: PA system, ceiling mounted projector, 10ft retractable screen and blackout blinds for windows

Natural light

Broadband Internet access

Can be used with the Patey Suite to create larger room, or breakout space

CAPACITY:

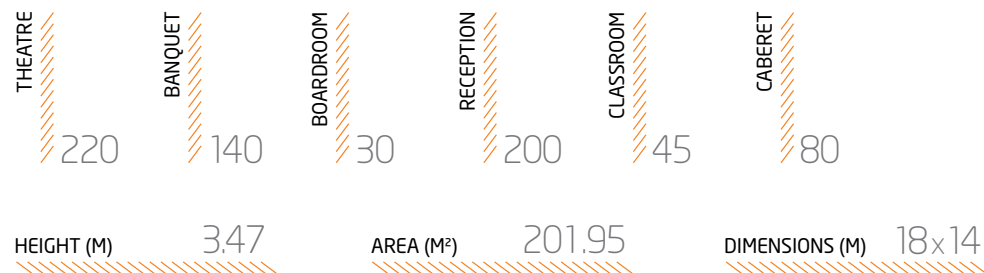

PATEY SUITE

The Patey Suite, located adjacent to the Murray Lecture Theatre, offers panoramic views of the arena through floor to ceiling windows running the length of the room. With a unique backdrop of a natural quarry rockface to the rear, it is a fantastic events room by itself or as a breakout space when used with the Lecture Theatre.

Ideal for formal / informal dinners, large / small meetings, presentations and other corporate events

Natural rockface backdrop

Broadband Internet access

Can be used in conjunction with the Murray Lecture Theatre

Breakout space

CAPACITY:

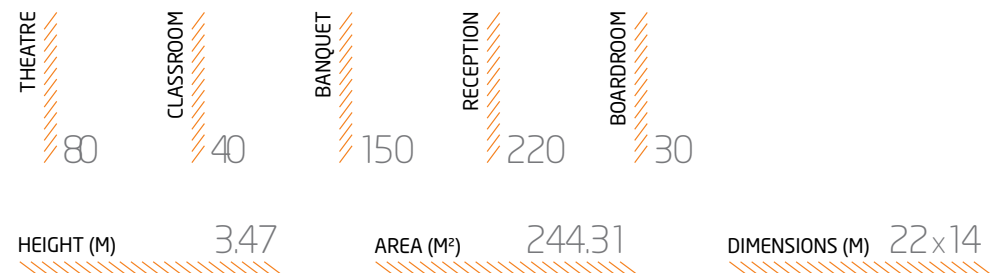



MARSHALL ROOM

The Marshall Room is decorated in a simple contemporary style, set in a boardroom format. Benefiting from natural light and looking onto the wooded area to the front, it is an ideal place to hold meetings with your colleagues or clients.

Ideal for meetings, presentations and other small corporate events

Can be used as a breakout room

Blackout blinds

Natural light

CAPACITY:

BANQUET 12
BOARDROOM 12

HEIGHT (M) 3.1

AREA (M²) 19.8

DIMENSIONS (M) 3.9x5.6

EICA FLOOR PLANS

HASTON SUITE

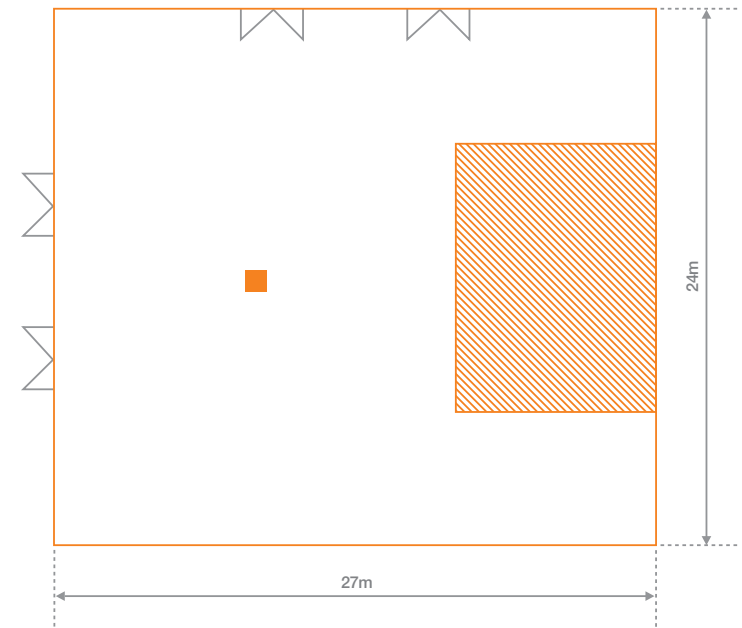

RAEBURN SUITE

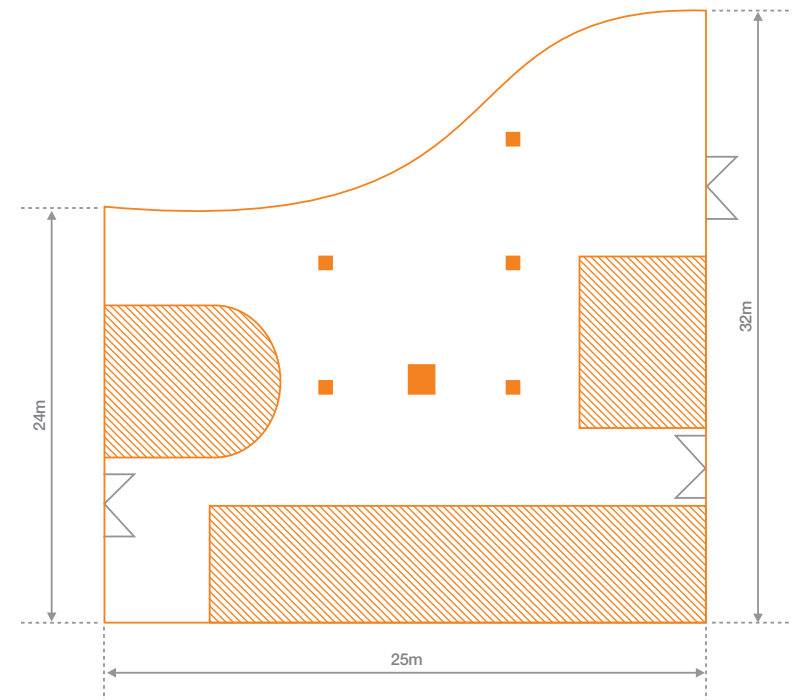

EICA FLOOR PLANS

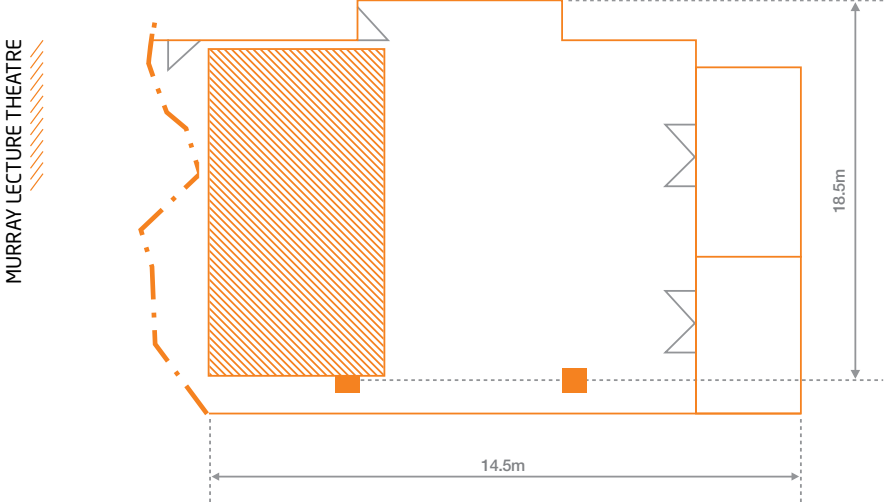
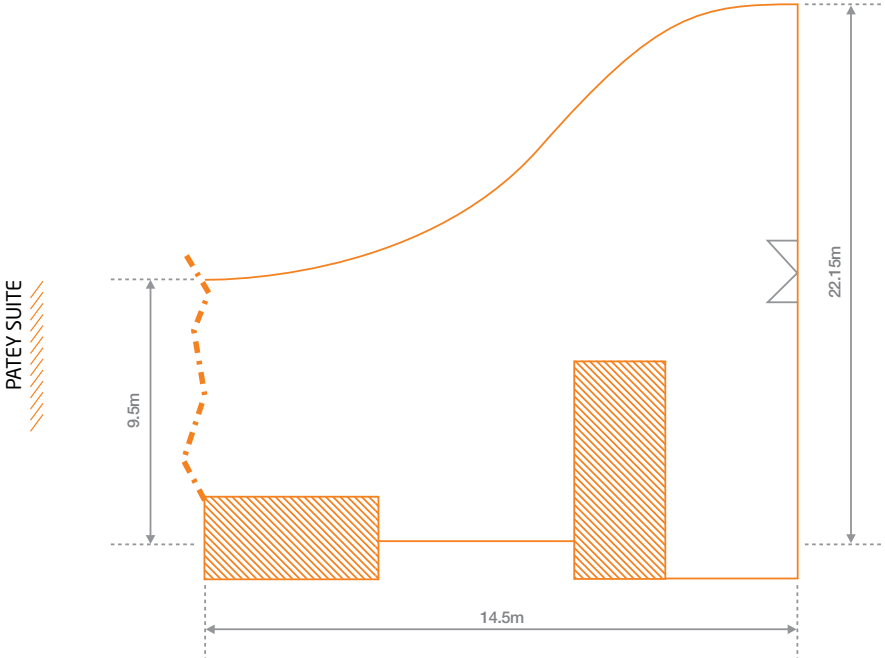



TEAM BUILDING

This inspiring, stimulating location takes you from the confines of your normal working day, and puts you at ease and open to the fantastic experiences that lie ahead.

Learning through having fun is one of the best ways to build lasting bonds which helps team performance back in the office. Every team building day can be built to suit the challenges you want your team to face... and we've got plenty to choose from.

In the world's largest indoor climbing arena it's a bit of a given that climbing and bouldering will form part of the team building activities available but, at EICA, you can do so much more than that. There's also the Aerial Assault course or abseiling to get your team moving and the adrenaline pumping.

Or why not take your team away from it all and join our instructors outdoors? Your team will face mental and physical challenges designed to create better workers, thinkers and team players.

“

THE ACTIVITIES WERE SUPERB AND EXTREMELY WELL RECEIVED BY THE GROUP. THE WHOLE DAY WAS GREAT VALUE FOR MONEY AND THE STAFF WERE EXCELLENT.

”

sportscotland

ACTIVITIES AT EICA

CLIMBING

If your team choose to take on the mighty walls, we can tailor-make an introductory climbing course to meet their needs.

From showing them the ropes, to providing expert knowledge and skills, they will be able to start climbing safely and effectively on the indoor walls in no time.

Trust is gained at an accelerated rate, with team members relying on the skill and support of their partners.

This shared experience helps members to be open to new ideas and generate innovative solutions to their problems.

AERIAL ASSAULT

If you want to challenge your team to the max, why not throw them off the Aerial Assault course 100 feet above the ground. A truly unique experience, they will quite literally let it all hang out!

The ride begins with a death-defying twisted zip slide and ends with a series of increasingly formidable obstacles.

MULTI ACTIVITIES

For the ultimate experience combine these two popular sessions and experience a 1-hour climbing session followed by our Aerial Assault Course.

TRADITIONAL ACTIVITIES

We've also got a range of more traditional team building activities that can be done indoors and outdoors, such as the UXB (Unexploded Bomb), Sheep & Shepherd, Nightline and Spiders Web, all of which will challenge your team to think and work together whilst enjoying a healthy dose of fun.

The team will have a great day but they'll also pick up skills which will help them work better when they get back to base.



OUTDOOR AND AWAY DAYS

ROCK CLIMBING

Experience the exhilaration of climbing on real rock; whether it is on the local crags, sea cliffs or big mountains, our instructors will lead you to the top.

HILL WALKING

From the Pentland Hills to Ben Nevis, we can guide your team across the beautiful scenery of Scotland's hills and mountains and guarantee lasting memories.

HALF DAY PACKAGE

This half day package is located in the beautiful surroundings of Roslin Glen, and has something for everyone.

The session includes a combination of orienteering, abseiling and team activities, with transport included if required.

OTHER ACTIVITIES

We can also organise charity abseils, hill walking expeditions, outdoor climbing sessions, as well as bringing our mobile climbing tower to you.



“

THE CARE AND ATTENTION TO DETAIL FROM MEMBERS OF STAFF AT THE EICA WAS FIRST CLASS. THEIR HELP WAS ABSOLUTELY INVALUABLE IN CREATING THE 'WOW' FACTOR.

”

Royal Incorporation of Architects (RIAS)

FINDING US



South Platt Hill
Newbridge
Edinburgh EH28 8AA

T: +44 (0)131 333 6333

F: +44 (0)131 333 6331

E: info.eica@edinburghleisure.co.uk

W: eica-ratho.com



Edinburgh Convention Bureau
Inspiring Conferences

Edinburgh Leisure

Managing leisure and recreation facilities for the City of Edinburgh Council

UNIQUE VENUES OF EDINBURGH